

FM Code	Product Code	Definition
DKLRKBYF	DK25 - FFM	Dilatation Expansion Joint With Tie Rods FM Approved Flanged $\pm 25$ mm Expansion
DKLRKBYF	DK50 - FFM	Dilatation Expansion Joint With Tie Rods FM Approved Flanged $\pm 50$ mm Expansion
DKLRKBYF	DK75 - FFM	Dilatation Expansion Joint With Tie Rods FM Approved Flanged $\pm 75$ mm Expansion
DKLRKBYF	DK100 - FFM	Dilatation Expansion Joint With Tie Rods FM Approved Flanged $\pm 100$ mm Expansion

**GENERAL**

Dilatation expansion joints are the interconnection elements that ensure uninterrupted and efficient operation of the installation in the joints of buildings with different foundations (Dilatation), by absorbing strain and rupture that can occur in the pipelines due to building collapses or earthquakes, and lateral deviations. These types of expansion joints consisting of double bellows can be fixed to the desired expansion amounts by using limit rods. They can be used at all Dilatation points in building passages.

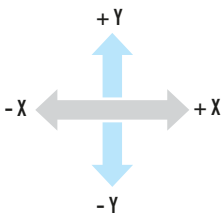

Standard Product Materials		Optional Product Materials
Bellows	1.4301 (AISI 304)	1.4541 / 1.4401 / Titanium / Incoloy 800H / Inconel etc.
Tie Rod Holders	1.0038 (St 37-2)	Stainless Steel
Flanges	1.0038 (St 37-2)	Stainless Steel
Intermediate Pipe	1.0038 (St 37-2)	Stainless Steel

Design Parameters	
Design Pressure	250 psi
Design Temperature	+20°C (-90°C...+550°C)
Diameters	DN25 (1")...DN250 (10")
Movements	X:60mm( $\pm 30$ ), Y:50mm ( $\pm 25$ ) / 100mm ( $\pm 50$ ) / 150mm ( $\pm 75$ ) / 200mm ( $\pm 100$ )
Standards	EJMA, EN 14917
Certifications	FM Approved - TSE - CE Module H (Optional) - EAC

\*\*Please contact our sales team for your special requests.

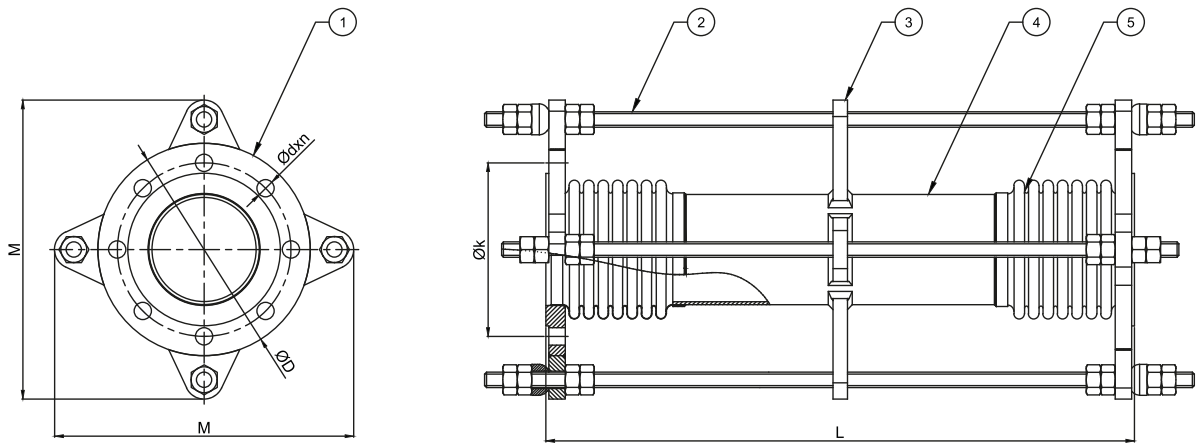

Part Number	Specifications	
	Name	Material
1	Flange	1.0038 (S235JR / St37-2)
2	Tie Rod	1.0038 (S235JR / St37-2)
3	Tie Rod Holder	1.0038 (S235JR / St37-2)
4	Intermediate Pipe	1.0038 (S235JR / St37-2)
5	Bellows	1.4301 (AISI 304)

Diameters		LENGTH (L = mm)				ØD (mm)	Øk (mm)	Ødxn (mm)	M (mm)	Effective Area (cm²)
		DKLRKBYF								
		DK25-FFM	DK50-FFM	DK75-FFM	DK100-FFM					
		X: ±30mm Y: ±25mm	X: ±30mm Y: ±50mm	X: ±30mm Y: ±75mm	X: ±30mm Y: ±100mm					
DN25	1"	260	360	460	560	115	85	14*4	195	19,0
DN32	1 1/4"	260	360	460	560	140	100	18*4	240	19,0
DN40	1 1/2"	260	360	460	560	150	110	18*4	254	24,7
DN50	2"	360	460	560	660	165	125	18*4	273	38,7
DN65	2 1/2"	360	460	560	660	185	145	18*4	285	58,0
DN80	3"	410	510	610	710	200	160	18*8	308	80,5
DN100	4"	410	510	610	710	220	180	18*8	328	129,0
DN125	5"	460	660	760	860	250	210	18*8	358	191,8
DN150	6"	460	660	760	860	285	240	22*8	413	262,7
DN200	8"	510	700	800	900	340	295	22*12	468	453,5
DN250	10"	600	800	900	1000	405	355	26*12	557	698,4

\*\* X,Y value represents axial, lateral movements. Please contact our technical department for different movement requirements.  
\*\* Flange diameters are according to PN16 pressure class.